



**COUNCILLORS' BULLETIN
WEDNESDAY, 3 JUNE 2020**



South
Cambridgeshire
District Council

CONTENTS

1. Meetings and events from Thursday 4 June to Friday 19 June 2020

Date	Time	Name	Venue	Contact
Thu 4 Jun	10:30 am	Licensing Appeals Sub-Committee	Virtual – Online Meeting	Victoria Wallace
Fri 5 Jun				
Mon 8 Jun				
Tue 9 Jun	5:20 pm	Scrutiny & Overview Committee	Virtual – Online Meeting	Victoria Wallace
Wed 10 Jun	10am	Planning Committee	Virtual – Online Meeting	Ian Senior
Thu 11 Jun				
Fri 12 Jun				
Mon 15 Jun				
Tue 16 Jun				
Wed 17 Jun				
Thu 18 Jun				
Fri 19 Jun				

INFORMATION FOR DISTRICT COUNCILLORS AND PARISH COUNCILS

2. A14 Road Closures for Week Commencing 1 June 2020

To contact your A14 sections stakeholder manager, please use the email addresses below or the A14 helpline.

John Birchall has now left the project. For all queries in relation to Section 1 & 2: Alconbury to the East Coast Main Line & Section 3: East Coast Main Line to Swavesey, please email A14CambridgeHuntingdon@highwaysengland.co.uk

Section 4 & 5: Swavesey to Milton
John Akester - John.Akester@thea14.com

Section 6: Huntingdon town centre
Liam Heath – liam.heath@thea14.com

A14 helpline **0800 270 0114** - This will be answered by a team member during site hours 8am - 5pm and messages can be left at other times. Further updates as the scheme progresses can be found on the [website](#).

GENERAL INFORMATION

3. Media Monitoring



The Council's Communications Team produce a weekly summary of recent news items which is published in the Bulletin to help keep members informed of recent coverage of the Council. Please contact the [Communications Team](#) for further information.

Date	Publication	Details		
27/05/2020	Cambridge Network online	Next steps published for Local Plan which determines how and where future homes and jobs will be created	Link	
27/05/2020	Cambridge News	New busway plans finalised	P4	GCP article. Cllr Aidan Van de Weyer quoted in GCP role
27/05/2020	Cambridge News	Public consultation helping to shape future of city	P8	
27/05/2020	Cambridge Independent	Adams Road cyclists celebrate busway win	P1, 8 & 9	GCP article. Cllr Aidan Van de Weyer quoted in GCP role
27/05/2020	Cambridge Independent	Draft plans reveal 8,000 home new 'border' district	P5	
27/05/2020	Cambridge Independent	Milton Country Park's £50,000 lifeline	P16	
27/05/2020	Cambridge Independent	Council adopts a Zero Carbon plan	P18	
27/05/2020	Cambridge News online	Exciting future for Cambridge homes, job, shops and more comes into view	Link	
28/05/2020	Royston Crow online	Greater Cambridge Local Plan report highlights next stage of development for county	Link	
28/05/2020	Cambridge News	Cherry Hinton development: 1,200 homes and two schools get initial go ahead	Link	
28/05/2020	The MJ	LGA split over worker bonus	Link	
28/05/2020	Planning Resource online	Go ahead on 1,200 Cambridge homes on site adjacent to airport	Link	Behind paywall. Unable to read full article
29/05/2020	Cambridge News	Plans for 1,200 homes on fields wins approval - despite strong opposition	P5	
29/05/2020	Cambridge News online	Legal row threatened in row between Mayor James Palmer and Greater Cambridge Partnership	Link	GCP / CA article
31/05/2020	Peterborough Matters online	Mayor and GCP row could cost taxpayers	Link	GCP / CA article
01/06/2020	Cambridge News	Threat of legal row over county transport project	P8 & P9	GCP / CA article
01/06/2020	Housing Today	Huge Cambridge fringe scheme approved	Link	
01/06/2020	Cambridge Independent online	1,200 homes and two new schools north of Cherry Hinton granted outline planning permission	Link	
01/06/2020	Transport Xtra online	Cambs Busway: GCP defies Palmer	Link	GCP / CA article
02/06/2020	Cambridge Network online	Council launches £200,000 fund to establish new Mobile Warden schemes in South Cambridgeshire	Link	

02/06/2020	Cambridge News	Dismay at beauty spot gatherings	P11	
02/06/2020	Cambridge News online	Dismay' at reports of large crowds at Cambridgeshire beauty spots	Link	
02/06/2020	Cambridge Network online	New funding to aid small South Cambs businesses in Covid-19 recovery	Link	

4. Items of Interest from the Local Government Association (LGA)



Items of Interest from the Local Government Association (LGA)

The Local Government Association provides a list of news headlines relevant to its members. Please click the headlines below for more details.

Friday 29 May, *Times*: [UK's largest solar farm approved](#)

Britain's largest solar farm, with almost 900,000 panels generating enough power for 91,000 homes, is to be build in Kent despite concerns about its effect on the countryside.

Sunday 31 May, *Channel 4 News*: [Councils face makings cuts without more funding](#)

The LGA says £3.2 billion in emergency government funding given to councils in England has met national cost pressures facing councils in the past three months but they will need double this amount to cope with the current COVID-19 emergency and beyond.

Monday 1 June, *BBC Online*: [Make Covid-19 recovery green, say business leaders](#)

More then 200 UK companies and investors are calling on the Government to deliver a coronavirus recovery plan which prioritises the environment.

5. View Planning Applications

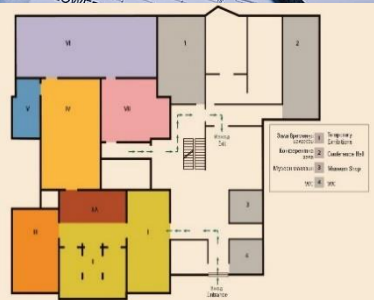

To view the list of planning applications that have recently been submitted to the Council, please visit the authority's on-line [Planning Application Search](#).

The system will provide a range of information on current and decided applications since 1948, including a brief description of the development, reference number, decision and the date of decision. More recent applications show the name and telephone number of the council officer who is dealing with the application.

Search results are presented in a collection of pages, the number of which depends on the number of results your search produces. There are navigation tools to allow you to browse your results.

EXECUTIVE DECISIONS TAKEN SINCE WEDNESDAY ...



In accordance with the [Access to Information Procedure Rules in Part 4 of the Council's Constitution](#), any executive decision shall be published normally within five days of being made. That record will bear the date on which it is published and will specify that the decision will come into force, and may then be implemented, on the expiry of 5 working days after the publication of the decision, unless called in for review by the Chairman of the Scrutiny and Overview Committee or by any five other councillors.

A list of decisions currently within the call-in period is available [on the Council's website](#).

The call in procedure is set out in full in [Part 4 of the Council's Constitution, 'Scrutiny and Overview Committee Procedure Rules'](#).

6. **Community Led Housing - Grant Application by Histon & Impington CLT**

Lead Cabinet Member for Housing **AGREED** to approve a community-led development grant of £4,500 to Histon & Impington Community Land Trust.

This decision was first published on 1 June and so the deadline for call-in is 8 June at 5pm.

DECISIONS MADE BY OFFICERS AND REPORTED FOR INFORMATION

Please click on the link below to find details of decisions made by officers under delegated authority:

<https://www.scambs.gov.uk/your-council-and-democracy/access-to-information/>

OTHER INFORMATION

7. Newly-Published Items on modern.gov

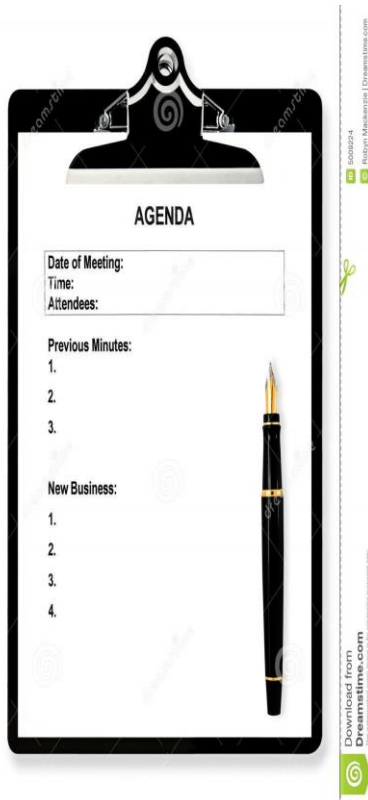

Agendas

- [Licensing Appeals Sub-Committee 4 June](#)
- [Scrutiny & Overview Committee 9 June](#)
- [Planning Committee 10 June](#)

Decisions

- [Planning Committee 26 May](#)
- [Civic Affairs Committee 2 June](#)
- [Community Led Housing – Grant Application](#)

Minutes

- [Scrutiny & Overview Committee 14 May](#)
- [Planning Committee 20 May](#)

Items

- [Joint Development Control Committee Terms of Reference](#)

This page is left blank intentionally.

Agenda Item 2

A14 Cambridge to Huntingdon, Cambridgeshire: major improvements

Construction work on the new A14 Cambridge to Huntingdon scheme is underway. We are currently carrying out a variety of tasks for which we need to close lanes or carriageways on the A1, A14 and some local roads at times, usually overnight between 8pm and 6am, unless otherwise stated. A clearly signed diversion route will always be in place for closures.

For this week, the planned closures are:

Full closures

Monday 1 to Friday 5 (five days) 8am - 6pm

- A1307 between Robins Lane, Lolworth and bottom of the 'jug handle' Bar Hill/Longstanton exit

Vehicles will be diverted via A14 Swavesey junction 24 and Bar Hill junction 25

Monday 1 to Friday 5 (five nights)

- A1 northbound Brampton Hut exit slip

Vehicles will be diverted north to Alconbury to then use A1 southbound and either continue or exit for access to Brampton Hut roundabout

- A1 northbound Brampton Hut entry slip

Vehicles will be diverted east along A141 and then north at Spittals roundabout to the spur road to re-join the A1 northbound at Alconbury

- A141 eastbound link between New Ellington junction 21 and Brampton Hut roundabout

Vehicles will be diverted east on the A605 at junction 13 then south on the A1(M) to the A605 to re-join the A14 at junction 21

- A14 eastbound Bar Hill junction 25 entry slip

Vehicles will be diverted west to Swavesey junction 24 to access the A14 eastbound

- A14 westbound Bar Hill junction 25 exit slip

Vehicles will be diverted to continue west to Swavesey junction 24 and return on the A14 eastbound to then exit for Bar Hill

- B1049 Bridge Road northbound at Histon junction 32

Vehicles will be diverted via A14 eastbound to Milton junction 33, A10 northbound, Butt Lane, Milton Road, Burgoynes Road and Impington Lane to access Histon & Impington.

- A10 southbound approach to Milton junction 33

Vehicles will be diverted via Butt Lane, Milton Road, Burgoynes Road, Impington Lane and B1049 Bridge Road to access Cambridge or the A14

Saturday 6 6am to Monday 8 6am

- A1307 Huntingdon Road inbound and outbound between Girton J31 westbound entry slip and Cambridge

Vehicles will be diverted via A14 eastbound to Histon junction 32 to access Cambridge

Saturday 6 (one night) 9pm – 8am

- Brampton Road B1514 between station car park and Edison Bell Way

Vehicles on the Huntingdon town centre side will be diverted onto the ring road, Ermine Street B1044 to Spittals roundabout, A141 west to Brampton / Brampton Racecourse junction and into Brampton via B1514. Vehicles on the Brampton side of the closure will follow this diversion in reverse.

For more information about this scheme, visit <https://highwaysengland.co.uk/a14-cambridge-to-huntingdon-improvement-scheme-home/>, or stay updated by following us on <https://twitter.com/a14c2h> and <https://en-gb.facebook.com/A14C2H/>.